

MANATÍ CENTRO PLAZA

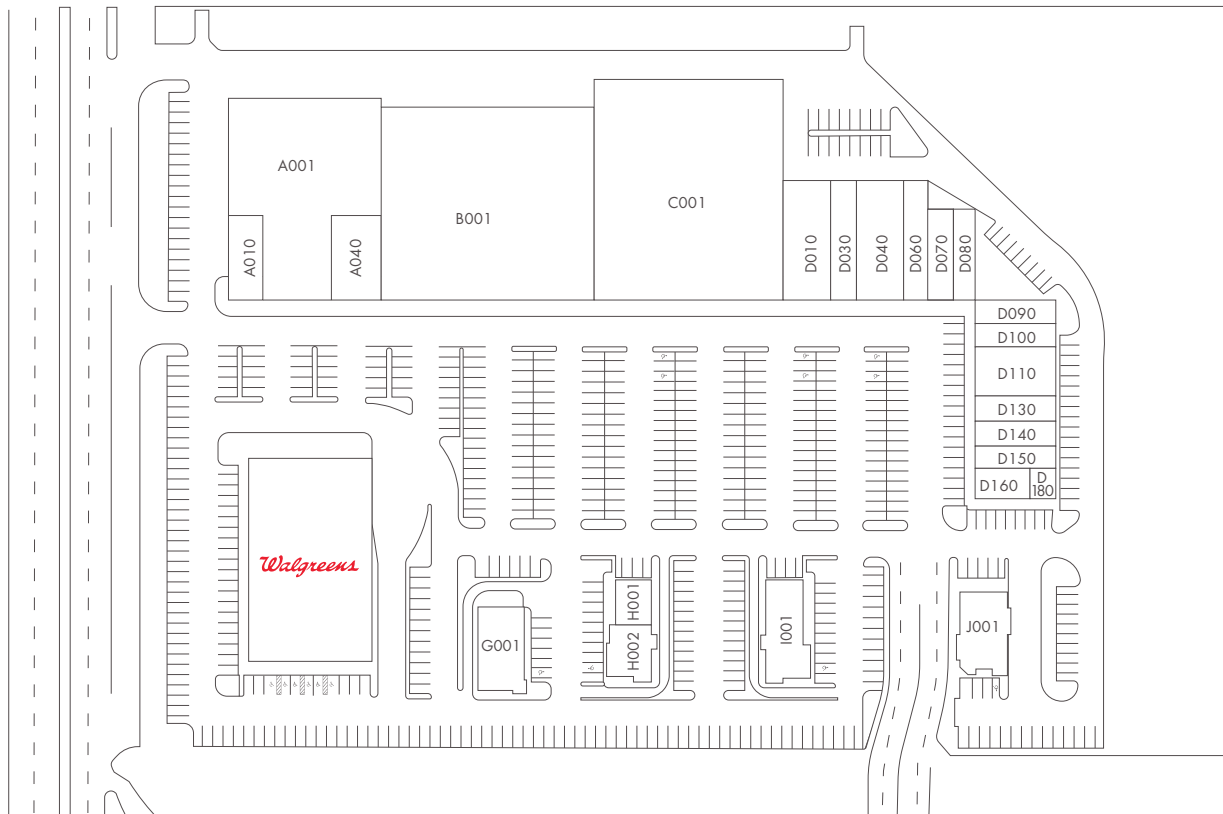

Anchor Stores	Marshalls, Capri, Grand Way
Hours of Operation	24/7
Location	#2 Bo. Cotto Norte Manati, PR 00674
Parking Spaces	456
Gross Leasable Area	117,872 Sq. Ft.

	1 mile	3 miles	5 miles	Estimated Census Numbers for Year 2021
Population	9,697	36,443	68,179	
Households	3,613	13,364	24,879	
Average Income	\$21,053	\$30,769	\$29,654	



Unit	Sq Ft	Name	Unit	Sq Ft	Name	Unit	Sq Ft	Name
A001	16,112	Grand Way	D060	2,160	MCS	D150	1,355	Claro
A010	1,296	Liberty	D070	1,722	Eye Wear	D160	1,165	Subway
A040	1,600	Party Decorations	D080	1,722	MCS	D180	575	Boost Mobile
B001	30,000	Capri	D090	1,355	GNC	G001	2,780	KFC
C001	29,500	Marshalls	D100	1,355	Cold Stone	I001	3,400	Wendy's
D010	4,340	Rent-A-Center	D110	2,710	T-Mobile	J001	2,500	Coop Manatí
D030	2,170	Sally Beauty Supply	D130	1,360	Marco's Pizza	H002	1,500	Taco Maker
D040	4,340	La Nueva Era	D140	1,355	Money Express	H001	1,500	Famosa China

FOR LEASING OPPORTUNITIES PLEASE CONTACT US AT:

T 787 622 9600 x.120 / 145 / 116 / 154
 PO Box 362983, San Juan, Puerto Rico 00936-2983

Plaza Caparra, Suite 201
 1498 Roosevelt Ave. & Parkside St.
 Guaynabo, Puerto Rico 00968

ymelendez@ccmpr.com
 mfvelez@ccmpr.com

www.ccmpr.com



CCM
PUERTO RICO
 A CCM Group Company